

The set includes:

1. Left piping - 1 pc.
2. Right piping - 1 pc.
3. Upper support - 1 pc.
4. M6x20mm bolt with washers and nut - 2 pcs.
5. 4mm spacer - 2 pcs.
6. M12x90mm bolt with washer - 1 pc.
7. M12x45mm bolt with washer - 1 pc.
8. M12x65mm bolt with washer - 1 pc.
9. M12x55mm bolt with washer - 1 pc.
10. M8x25mm bolt with washers and nut - 2 pcs.

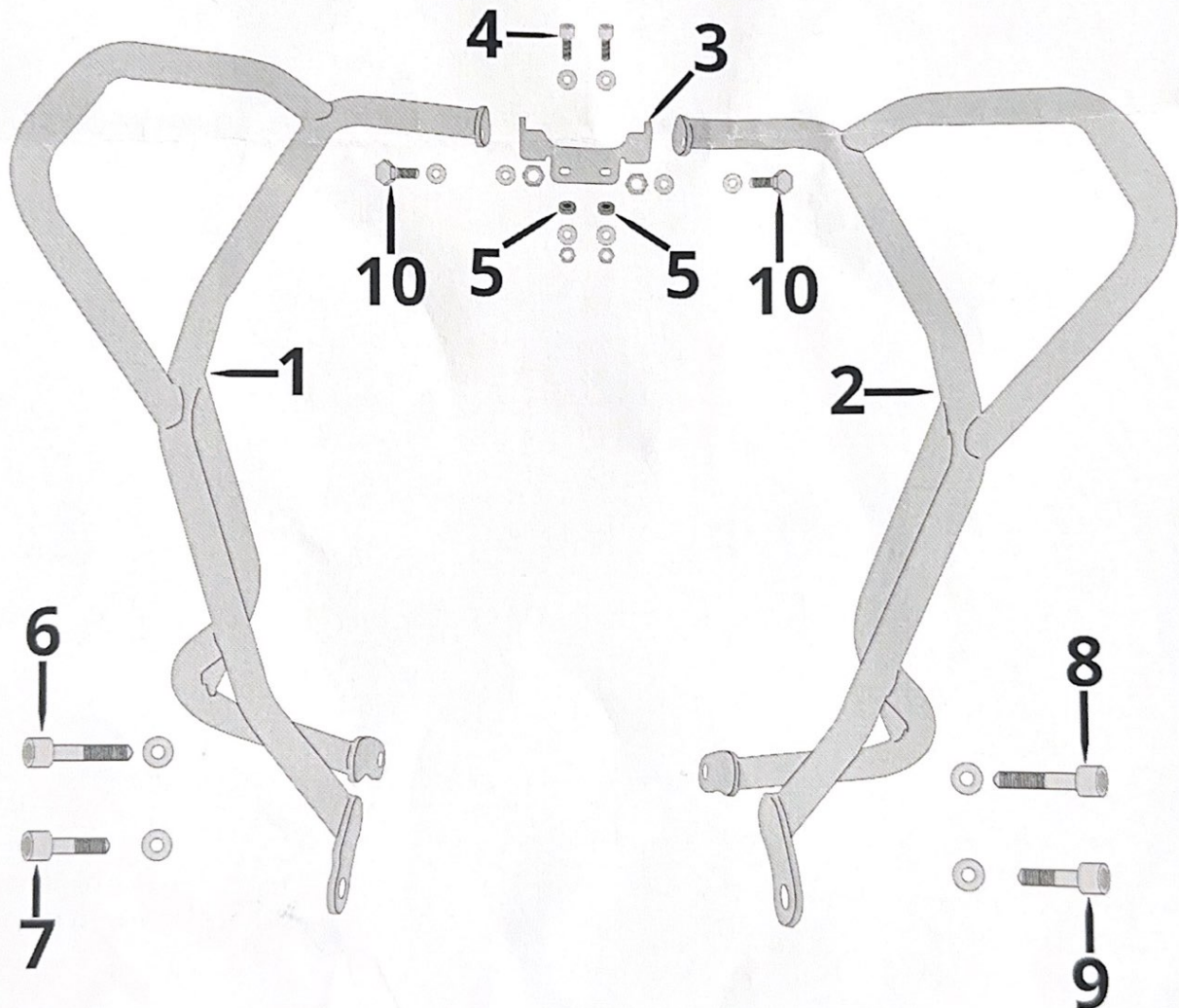

1. Remove factory engine guard (Fig. 1 pt. 11).
2. Install upper support (Fig. 2 pt. 3) by fixing it to fairing subframe under the headlight using in empty holes 2 bolts M6x20 mm with nuts (Fig. 2 pt. 4) and place two 4mm spacers (Fig. 2 pt. 5) between the support and the subframe.



**Attention!**  
It is necessary to support the engine with a jack before loosening any engine bolts to prevent it from moving downward.

3. Remove 2 engine bolts (Fig. 3 pt. 6 & 7) from the left side of the motorcycle.



**Attention!**  
Please pay attention to the spacers present between motorcycle frame and the engine on bolts, which are removed! Spacers must remain in their places.

4. Install left crash bar (Fig. 4 pt. 1):
  - in front part of the motorcycle using M12x90 mm bolt (Fig. 4 pt. 6) in place of the bolt removed in step 3,
  - in rear part of the motorcycle using M12x45 mm bolt (Fig. 4 pt. 7) in place of the second bolt removed in step 3,
  - fix it to the upper support (Fig. 5 pt. 3) using M8x25 mm bolt with nut (Fig. 5 pt. 10).

Do not tighten the bolts.

5. Remove 2 engine bolts on the right side of the motorcycle (Fig. 6 pt. 8 & 9)



**Attention!**  
Please pay attention to the spacers present between motorcycle frame and the engine on bolts, which are removed! Spacers must remain in their places.

6. Install right crash bar (Fig. 7 pt. 2):
  - in front part of the motorcycle using M12x65 mm bolt (Fig. 7 pt. 8) in place of the bolt removed in step 3,
  - in rear part of the motorcycle using M12x55 mm bolt (Fig. 7 pt. 9) in place of the second bolt removed in step 3,
  - fix it to the upper support (Fig. 7 pt. 3) using M8x25 mm bolt with nut (Fig. 7 pt. 10).

Do not tighten the bolts.

7. Align crash bars to the motorcycle equally on both sides and tighten the bolts.

8. Remove the jack and reinstall engine guard removed in step 1.

Tighten the screws to the final torque values provided in the "The set includes" section. If no torque values are provided for the screws, refer to the motorcycle specifications. After riding 50 km, it is recommended to check the tightness of all screws.

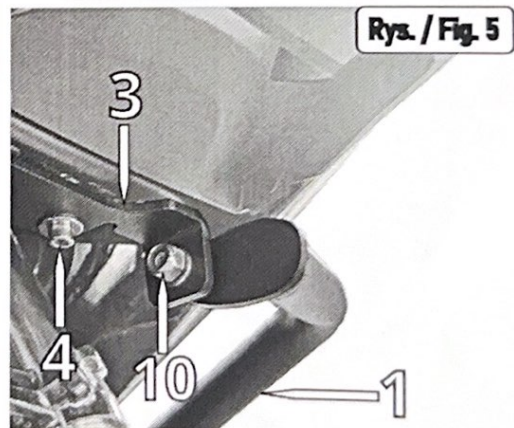
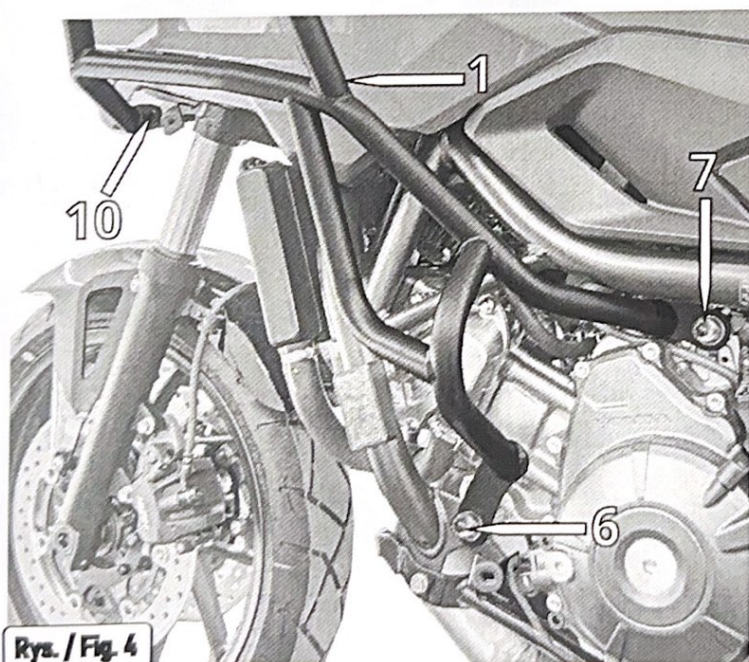
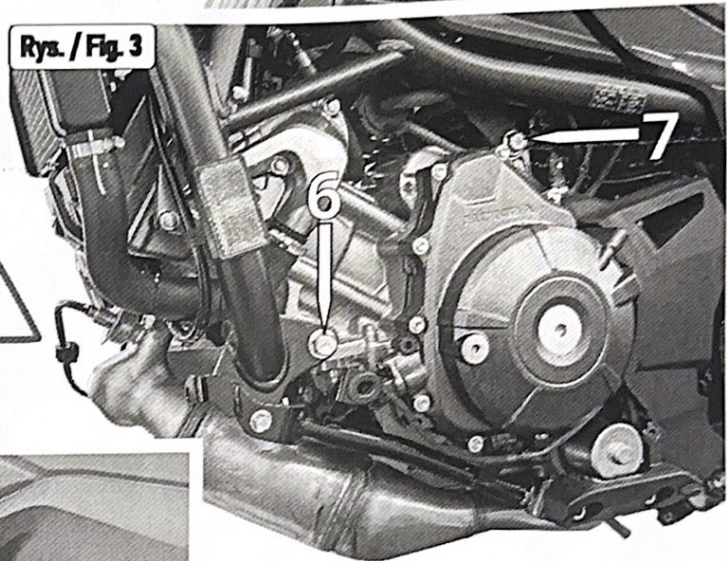
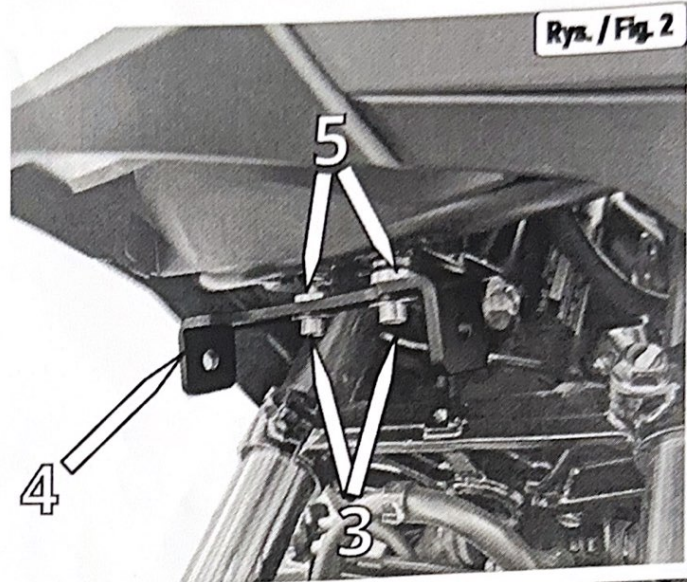
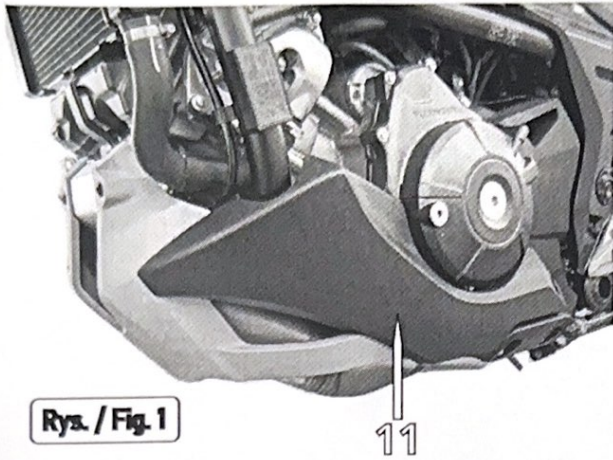

Rys. / Fig. 6

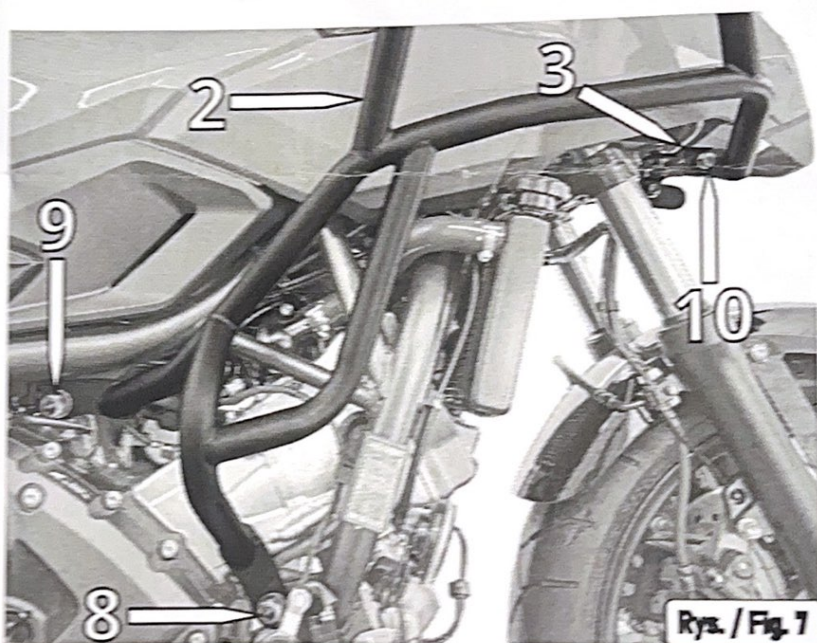
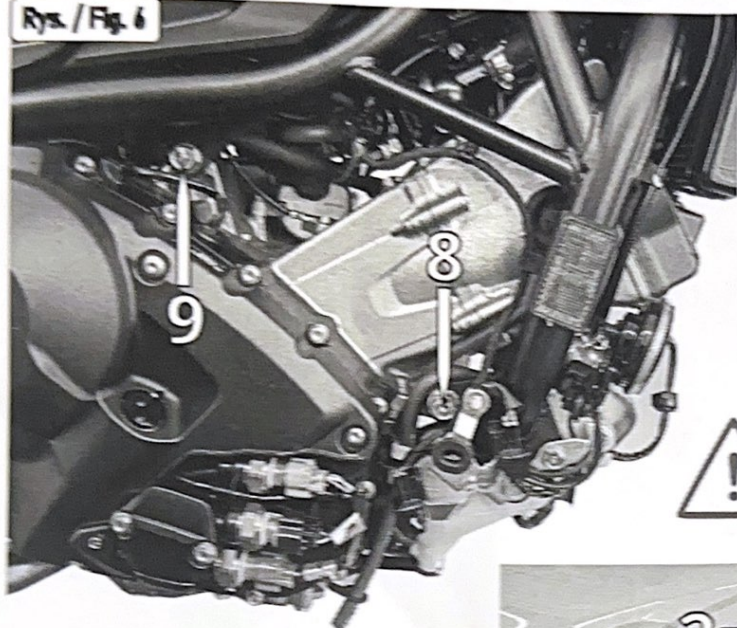

Rys. / Fig. 7

Rys. / Fig. 8

