

The set includes:

1. Left piping - 1 pc.
2. Right piping - 1 pc.
3. M8x30 mm bolt with washer - 4 pcs. - 34Nm
4. M8x14 mm bolt with washer - 4 pcs. - 20Nm

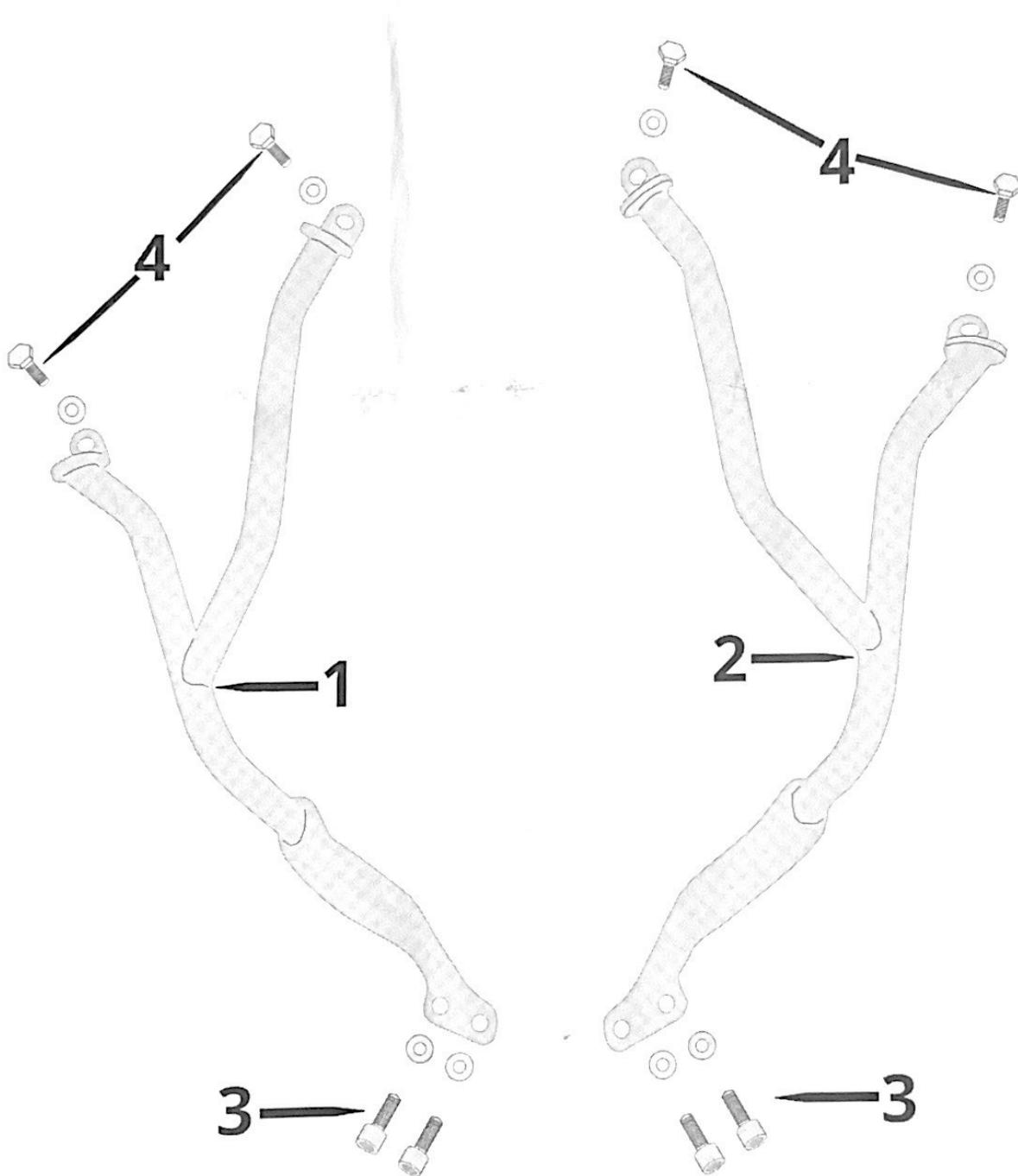



1. Remove on the left lower part 2 bolts connecting a subframe to the motorcycle frame (Fig. 1 pt. 3).
2. Install the left crash bar (Fig. 2 pt. 1):
 - - in the lower part, screw in using 2 bolts M8x30 mm in place of the bolts removed in step 1 (Fig. 2 pt. 3),
 - - in the upper part, screw in using 2 bolts M8x14 mm to the threaded mounting holes on the lower inner side of the upper left HEED crash bar model YAMUP0310 (Fig. 2 pt. 4).



Attention!

Due to limited access to the upper mounting points of the crash bar, a flex wrench will be useful when tightening them.

3. Remove from the right side in the lower rear part 2 bolts connecting a subframe to the motorcycle frame (Fig. 3 pt. 3).
4. Install the right crash bar (Fig. 4 pt. 2):
 - in the lower part, screw in using 2 bolts M8x30 mm in place of the bolts removed in step 3 (Fig. 4 pt. 3),
 - in the upper part, screw in using 2 bolts M8x14 mm to the threaded mounting holes on the lower inner side of the upper right HEED crash bar model YAMUP0310 (Fig. 4 pt. 4).

Tighten the screws to the final torque values provided in the "The set includes" section. If no torque values are provided for the screws, refer to the motorcycle specifications. After riding 50 km, it is recommended to check the tightness of all screws.

