

The set includes:

1. Left piping – 1 pc.
2. Right piping – 1 pc.
3. Front bracket – 2 pcs.
4. M8x60 mm bolt with washers and nut – 2 pcs. -23Nm
5. Spacer sleeve 39 mm – 1 pc.
6. M8x70 mm bolt with washers and nut – 1 pc. – 30Nm
7. M8x25 mm bolt with washer – 4 pcs. – 30Nm
8. M12x80 mm bolt with washer – 1 pc. – 75Nm
9. M12x90 mm bolt with washer – 1 pc. – 75Nm
10. Plastic plug – 4 pcs.

Additional elements available in the YAMUP0310CM4VR version:

11. M6x25mm bolt with 22 mm widened washer – 2 pcs. – 8Nm
12. M6x30 mm bolt with washer – 2 pcs. – 8Nm
13. Spacer sleeve 16 mm – 4 pcs.

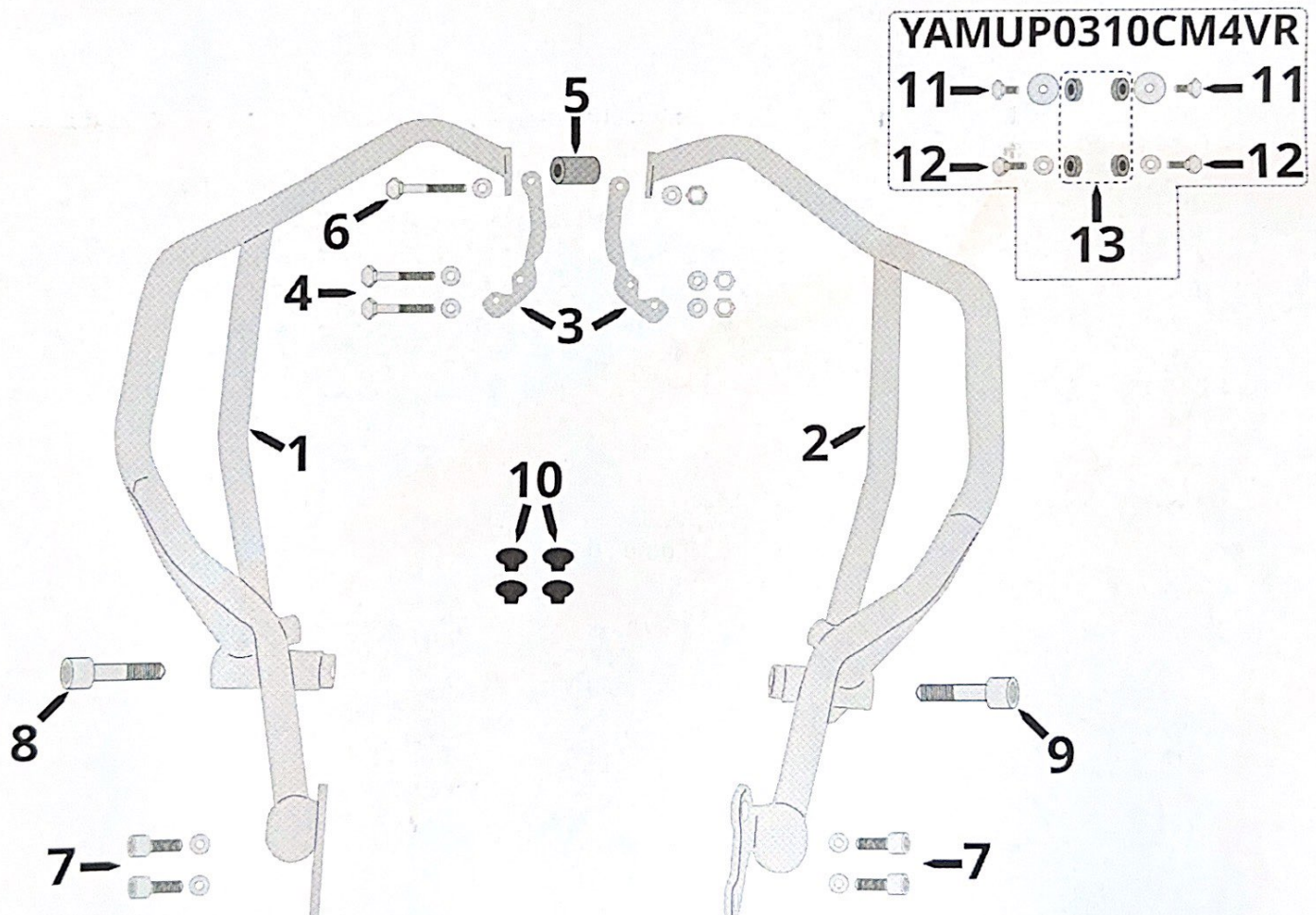



Attention!

Before installing the crash bars, remove the engine cover (if installed on the motorcycle) and support the motorcycle engine with a jack. This is necessary to avoid lowering the engine after removing the engine bolts. The jack can only be removed after completing the crash bar installation and final tightening of all bolts.



Information

If the motorcycle does not have a high fender, skip step 1 and go straight to step 2.

1. Remove the high fender (**Fig. 1 pt. 14**) by unscrewing 4 bolts fixing it to the upper fork bridge. When removing the fender, pay attention to the brake hose bracket, which will have to be reinstalled on place after the installation is complete (**Fig. 1 pt. 15**).
2. Remove 2 bolts connecting the fairing subframe to the frame head (**Fig. 2 pt. 4**).



Information

When removing the bolts, remove also sleeves located on both sides of them.

3. In place of bolts removed in step 2, attach 2 front brackets (**Fig. 3 pt. 3**) using 2 bolts M8x60 mm (**Fig. 3 pt. 4**) and placing the sleeves removed in step 2 between the brackets and the frame.
4. Remove the engine bolt on the left side of the motorcycle near the fairing (**Fig. 4 pt. 8**).



Attention!

Do not remove the engine bolts indicated in steps 4 and 5 at the same time as the corresponding bolts on the right side of the motorcycle.

5. Remove 2 bolts connecting the engine to the motorcycle frame on the left side (**Fig. 4 pt. 7**).
6. Install the left crash bar (**Fig. 5 pt. 1**):
 - in the front part, screw the crash bar in place of the bolt removed in step 4 using an M12x80mm bolt (**Fig. 5 pt. 8**),
 - in the rear part, screw in place of the bolts removed in step 5 using 2 bolts M8x25 mm (**Fig. 5 pt. 7**).
7. Remove engine bolt on the right side of the motorcycle near the fairing (**Fig. 6 pt. 9**). Pay special attention to the original centering sleeve in the frame socket, it should remain in its place.



Attention!

Do not unscrew the bolts on the right side of the motorcycle before screwing in all the bolts holding the left crash bar. Unscrewing the bolts on both sides at the same time may damage the motorcycle.



8. Remove 2 bolts connecting the engine to the motorcycle frame on the right side (Fig. 6 pt. 7).
9. Install the right crash bar (Fig. 7 pt. 2):
 - in the front part, screw the crash bar in place of the bolt removed in step 7 using the M12x90 mm bolt (Fig. 7 pt. 9),
 - in the rear part, screw in place of the bolts removed in step 8 using 2 bolts M8x25 mm (Fig. 7 pt. 7).



Attention!

Pay attention to the original centering sleeve mentioned in step 7, it should remain in place (Fig. 7 !).

10. Place the 39 mm spacer sleeve (Fig. 7 pt. 5) between the front brackets installed in step 3 and connect both parts of the piping to the brackets using the M8x70 mm bolt (Fig. 7 pt. 6).
11. Adjust both parts of the crash bars symmetrically to the motorcycle and tighten all the bolts that secure them.
12. On motorcycles equipped with a high mudguard, reinstall the mudguard using the elements from the installation kit (pts. 11-13):
 - in the front part using 2 bolts M6x25 mm with a widened washer (Fig. 8 and 9, pt. 11) placing a 6 mm spacer sleeve between the mudguard and the motorcycle (Fig. 8, pt. 13)
 - in the rear part using 2 bolts M6x30 mm with washers (Fig. 8 and 9, pt. 12) while simultaneously fixing the brake hose holder (Fig. 8 and 9, pt. 15) and placing a 6mm spacer sleeve between the mudguard and the motorcycle (Fig. 8, pt. 13).

Tighten the screws to the final torque values provided in the "The set includes" section. If no torque values are provided for the screws, refer to the motorcycle specifications. After riding 50 km, it is recommended to check the tightness of all screws.

Rys. / Fig. 1

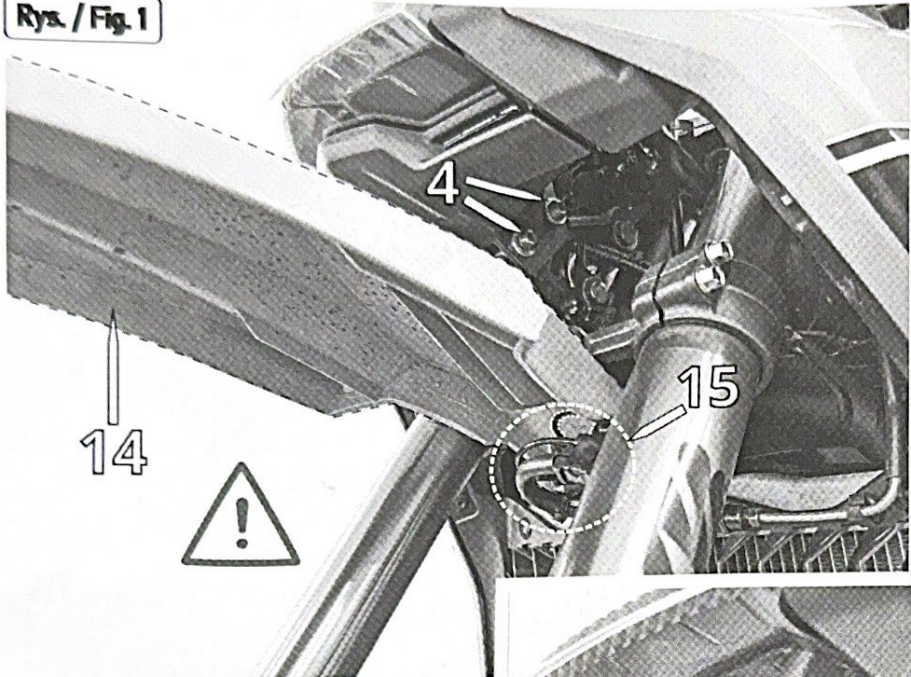

Rys. / Fig. 2

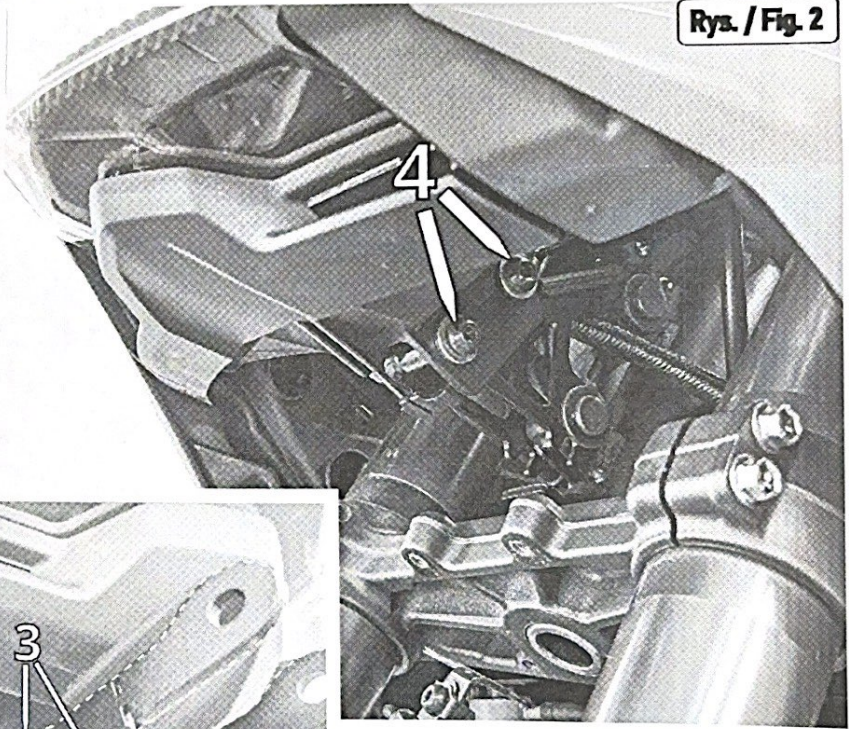

Rys. / Fig. 3

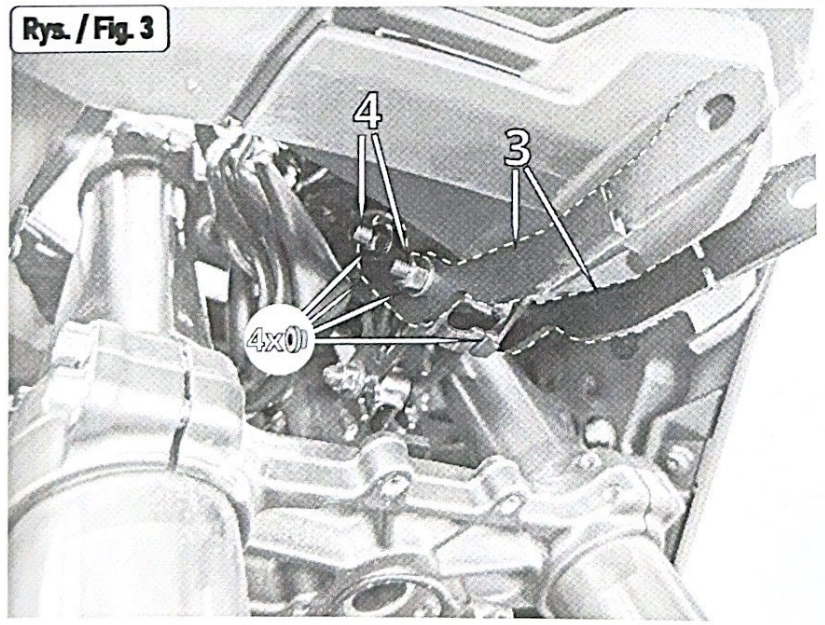

Rys. / Fig. 4

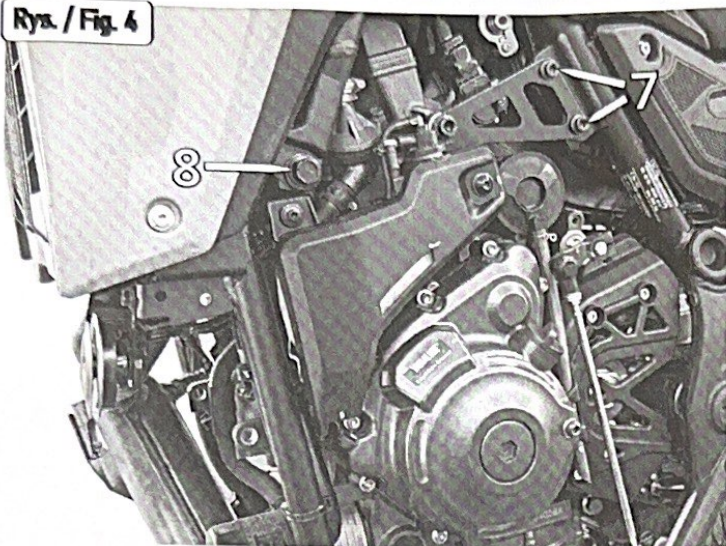

Rys. / Fig. 5

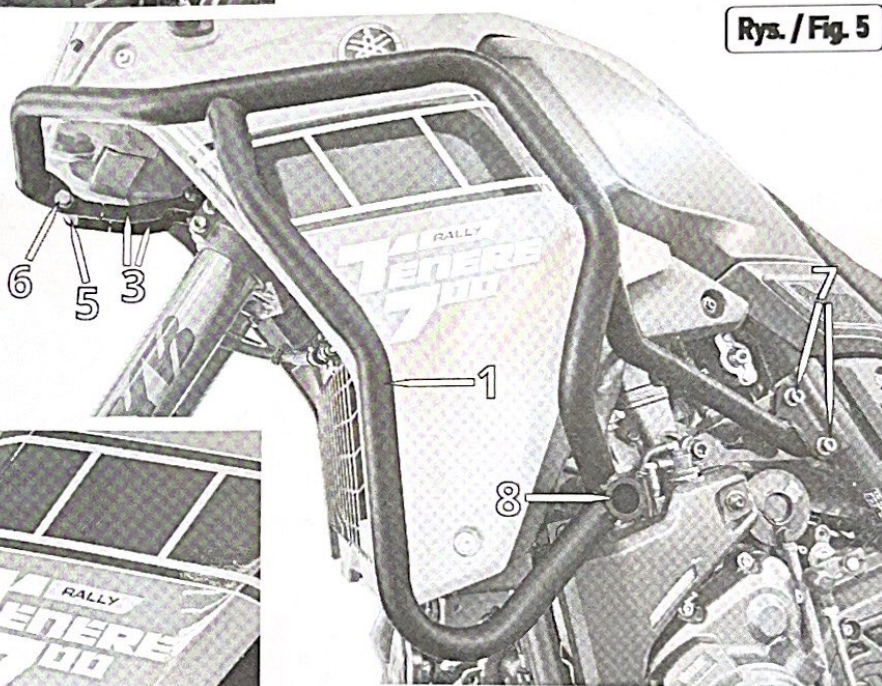

Rys. / Fig. 5

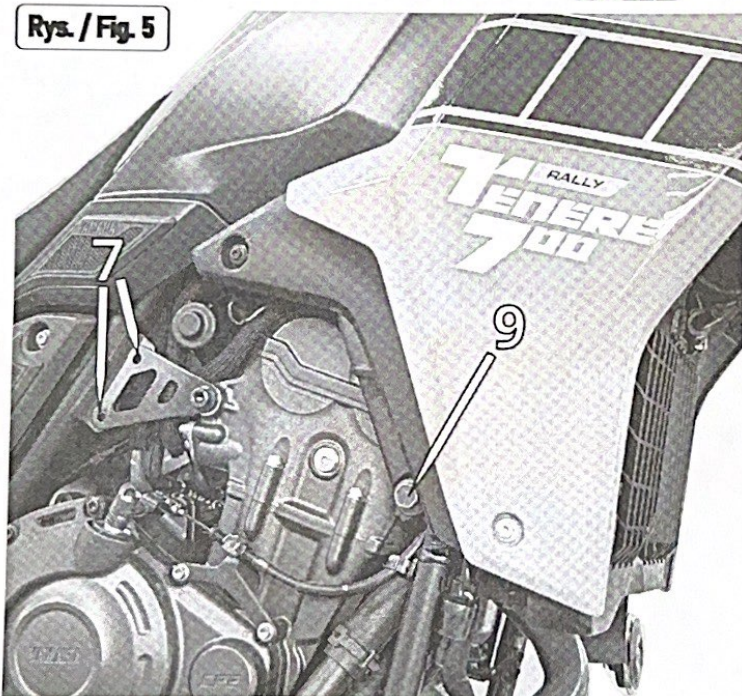



Rys. / Fig. 6

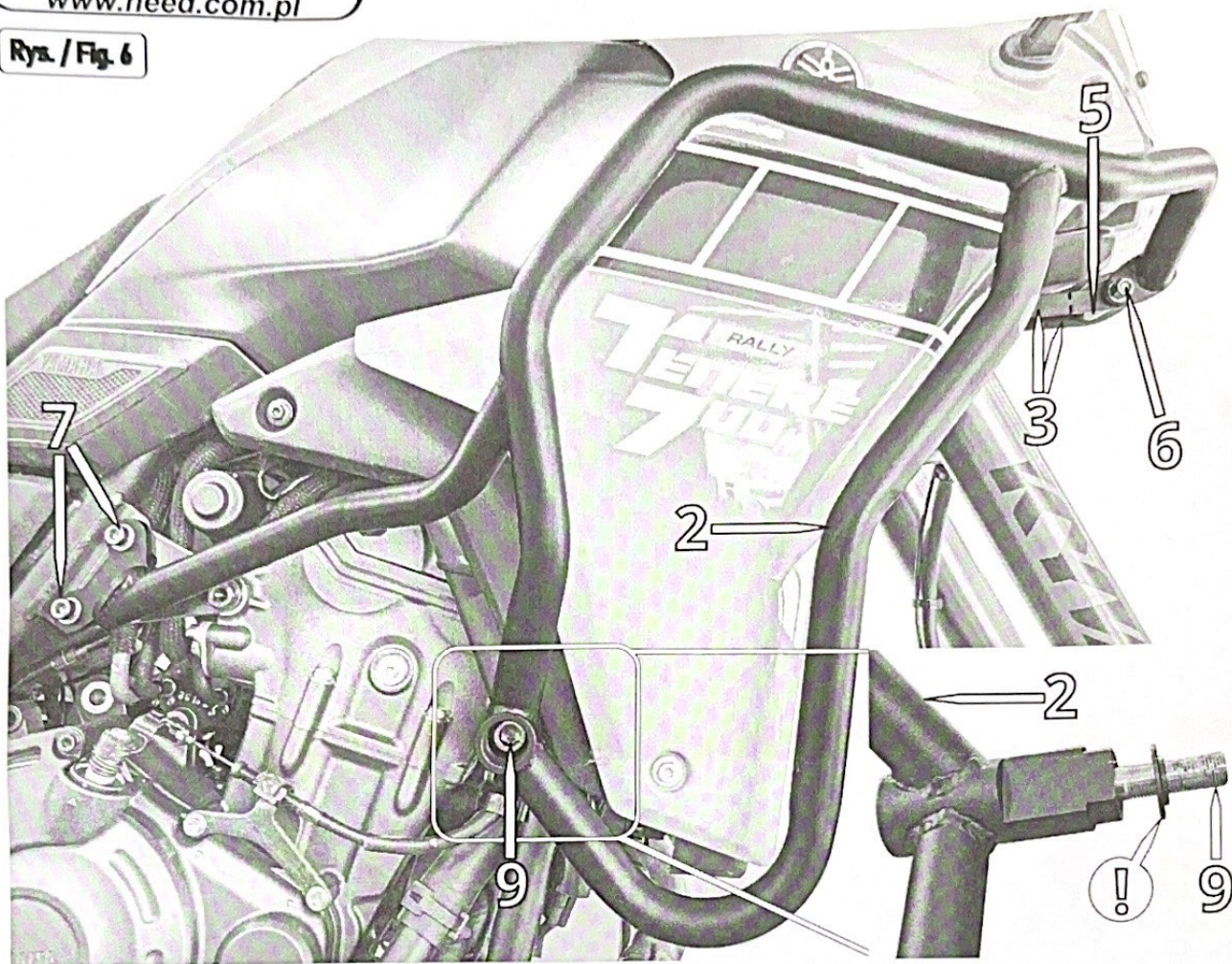

Rys. / Fig. 8

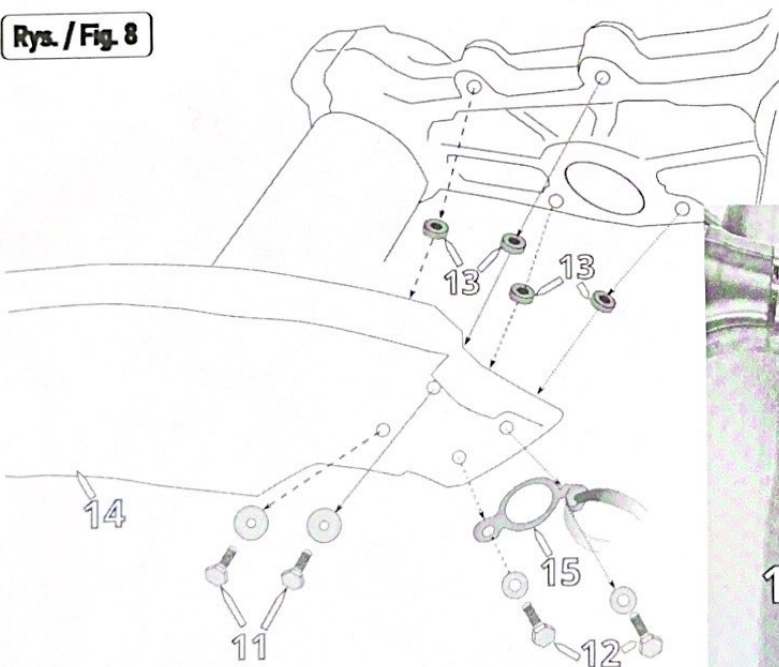

Rys. / Fig. 9

